

# MAGELLAN DESIGNS

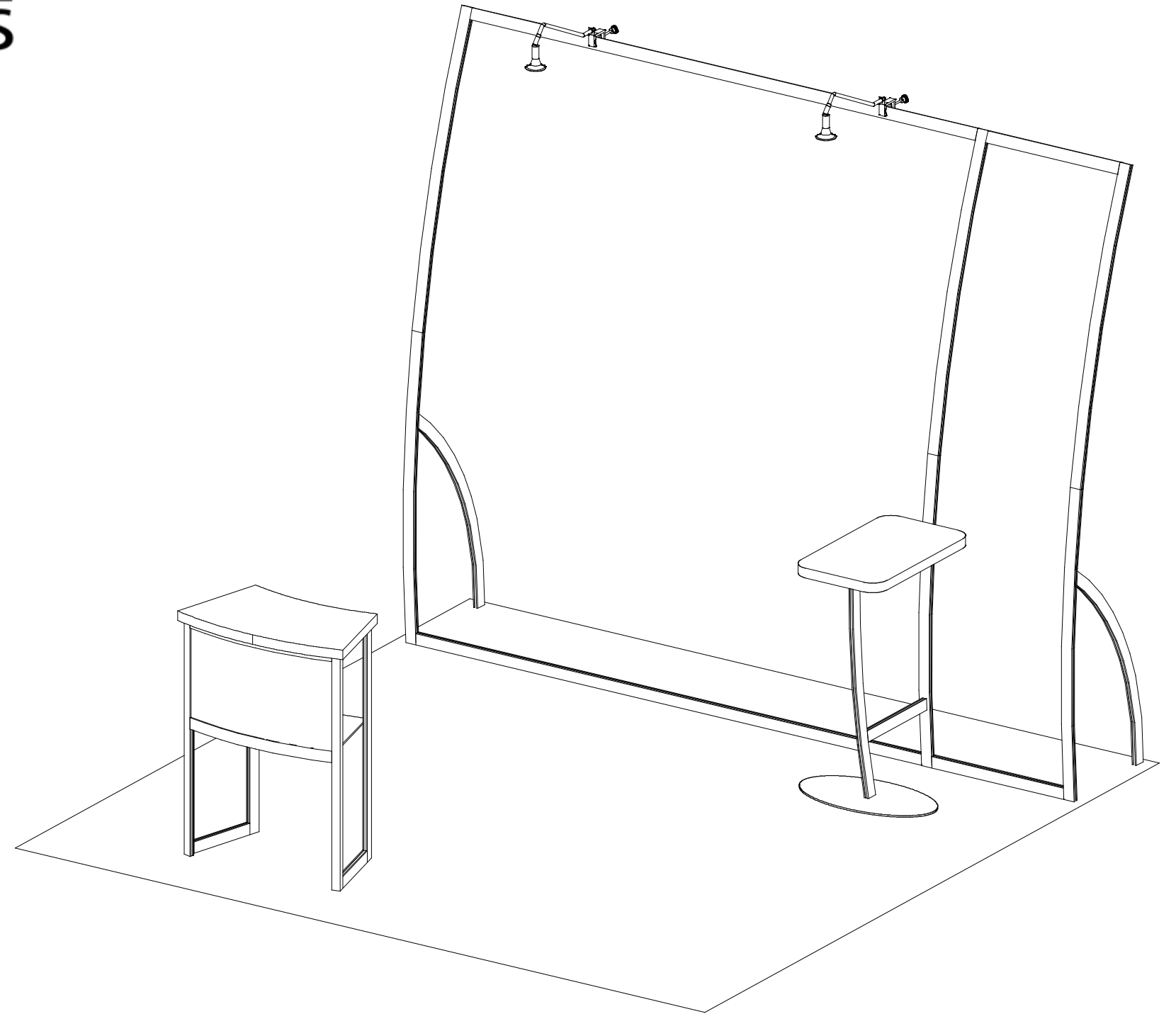
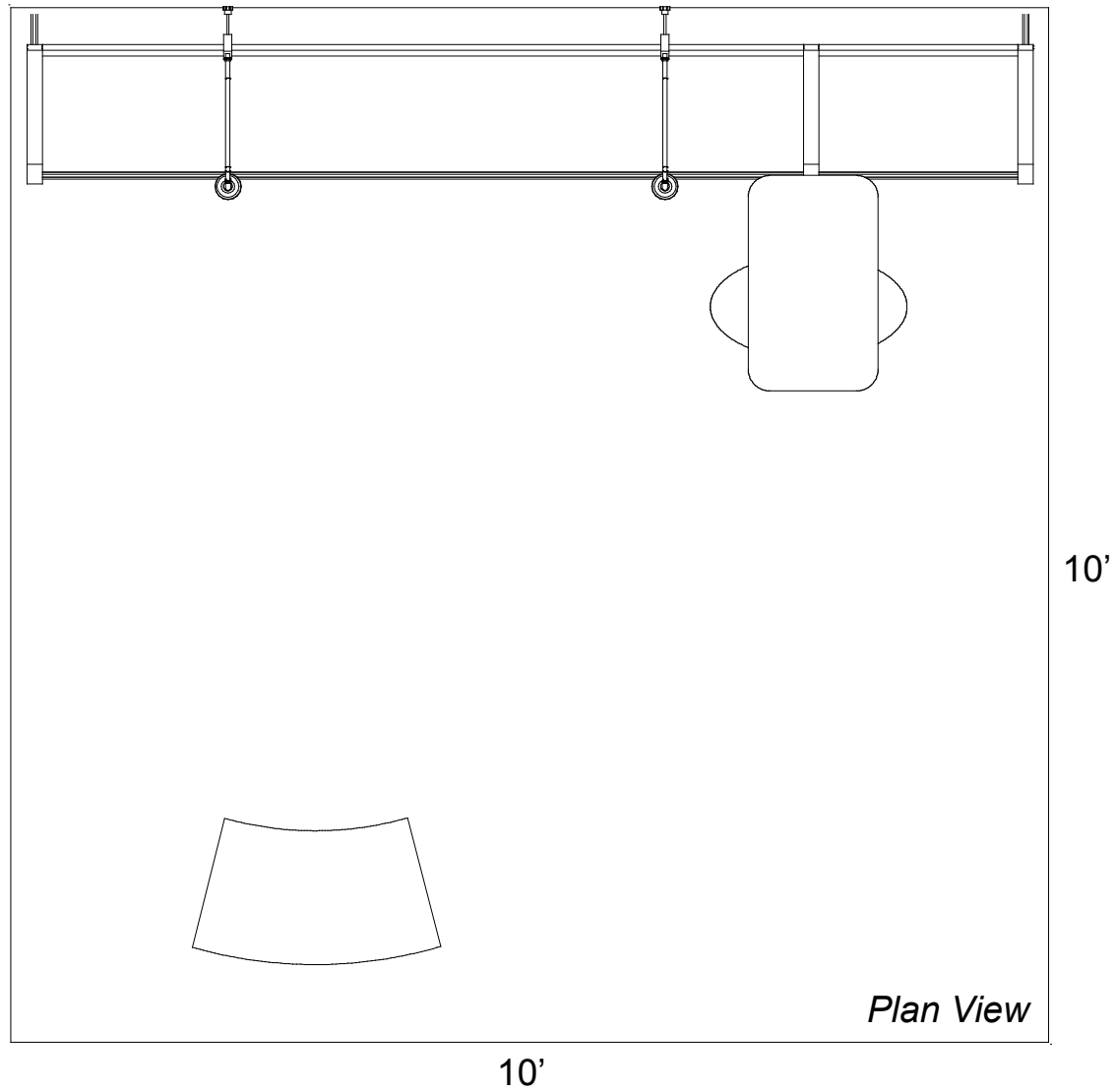

WHEN DISASSEMBLING ALUMINUM EXTRUSION, TIGHTEN ALL SETSCREWS AND LOCKS TO PREVENT LOSS DURING SHIPPING

# MAGELLAN DESIGNS

## Using Your Set-up Instructions:

The Visionary Designs Set-up Instructions for Magellan displays are created specifically for your configuration. They are laid out sequentially, including an exploded view of the entire display and a logical series of detailed steps for assembly. We encourage you to study the instructions **before** attempting to assemble your exhibit.

### THIS IS VERY IMPORTANT!

Each page reminds you to tighten the setscrews after disassembling your exhibit to prevent loss of the locks and setscrews (see below in red).

## Cleaning & Packing Your Display:

- 1) Use care when cleaning aluminum extrusions or acrylic inserts. Use only non-abrasive cleaners.
- 2) When cleaning laminate inserts or counter tops, use mild cleansers and a soft material such as cotton.
- 3) Keep all display components away from extreme heat and long exposure to sunlight to avoid warping and fading.
- 4) Retain all packing materials. It will make re-packing much easier and will reduce the likelihood of shipping damage.

Hex Key Tool



Most visionary design exhibits can be assembled with the supplied Hex Key Tool. Occasionally, a flat head screwdriver may be required.

Typical Connection



**Detail A:** Most horizontal extrusion connections have a patented expandable lock. This lock inserts into the groove of an opposing extrusion. Tightening the lock with the Hex Key Tool expands the lock and creates a strong positive connection.

Typical Connection



Numbered Label

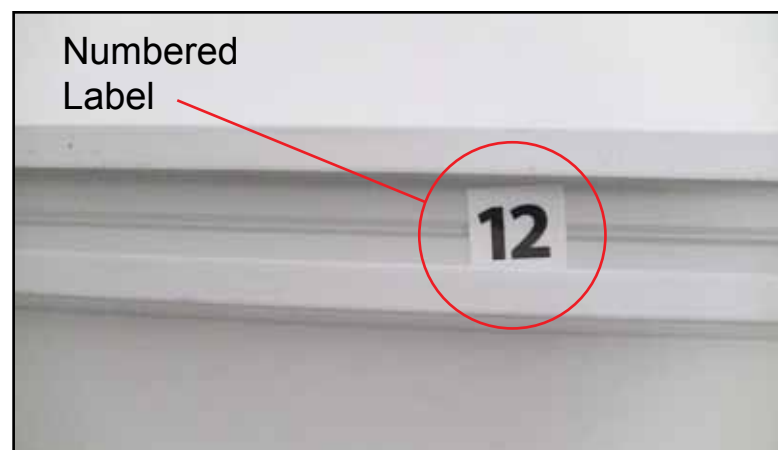

**Detail B:** Each extrusion contains a numbered label that corresponds to set-up instructions. The label is located within a groove of the extrusion (when possible). Visionary Design labels contain Black numbers unless otherwise specified.

Horizontal Connection

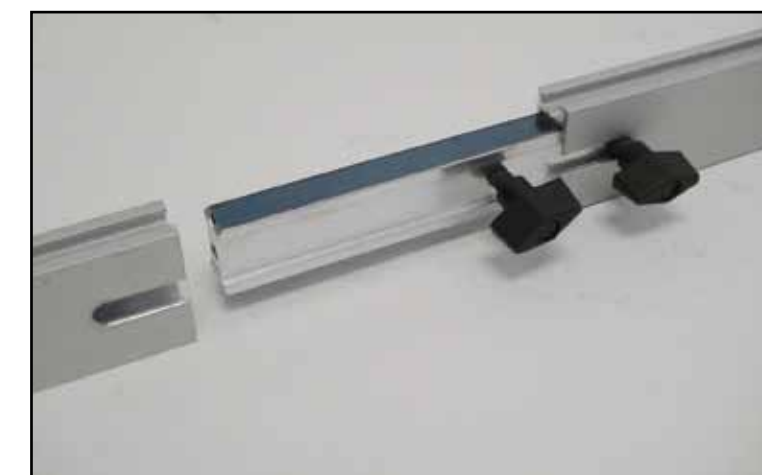

**Detail C:** A rectangular connection bar with plastic T Knobs is inserted between two horizontal extrusions joined end-to-end. Turn the knobs clockwise to tighten. Do Not Overtighten.

**WHEN DISASSEMBLING ALUMINUM EXTRUSION, TIGHTEN ALL SETSCREWS AND LOCKS TO PREVENT LOSS DURING SHIPPING**

866.652.2100

| Part # | Qty | Description                      |
|--------|-----|----------------------------------|
| 1      | 1   | 48.5" h Lower Curved Extrusion   |
| 2      | 1   | 48.5" h Upper Curved Extrusion   |
| 3      | 1   | 48.5" h Lower Curved Extrusion   |
| 4      | 1   | 48.5" h Upper Curved Extrusion   |
| 5      | 1   | 48.5" h Lower Curved Extrusion   |
| 6      | 1   | 48.5" h Upper Curved Extrusion   |
| 7a/7b  | 1/1 | 44" w Lower Horizontal Extrusion |
| 8a/8b  | 1/1 | 44" w Upper Horizontal Extrusion |
| 9      | 1   | 23" w Lower Horizontal Extrusion |
| 10     | 1   | 23" w Upper Horizontal Extrusion |
| 11     | 1   | Backwall Support Leg Extrusion   |
| 12     | 1   | Backwall Support Leg Extrusion   |

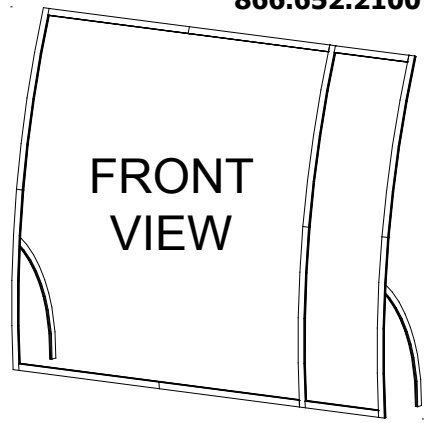
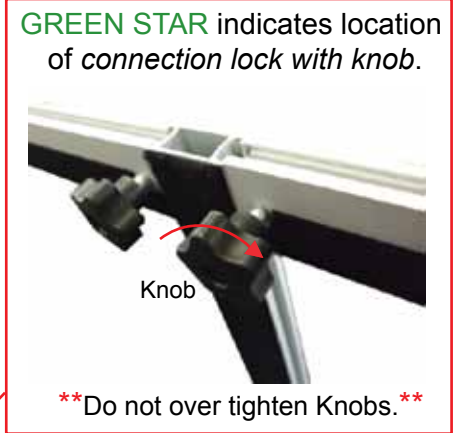
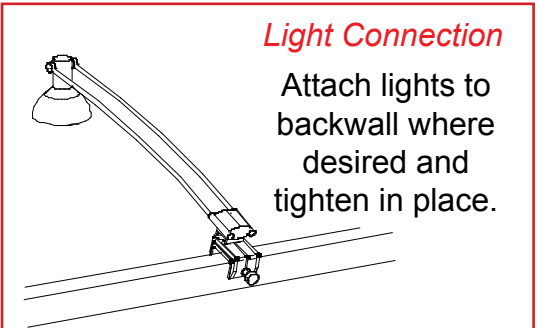

**Steps**

- Unit can be assembled face down on the floor then lifted upright.*
- 1) Connect backwall upper and lower verticals together [ 1 to 2, 3 to 4 and 5 to 6].
  - 2) Connect horizontal extrusions together [7a to 7b and 8a to 8b].
  - 3) Attach horizontal assemblies [7a/7b and 8a/8b] between vertical assemblies [1/2 and 3/4].
  - 4) Attach horizontal extrusions [9 and 10] between vertical assemblies [3/4 and 5/6].
  - 5) Attach support leg extrusions [11 and 12] to back of verticals [1 and 5], see leg attachment detail.

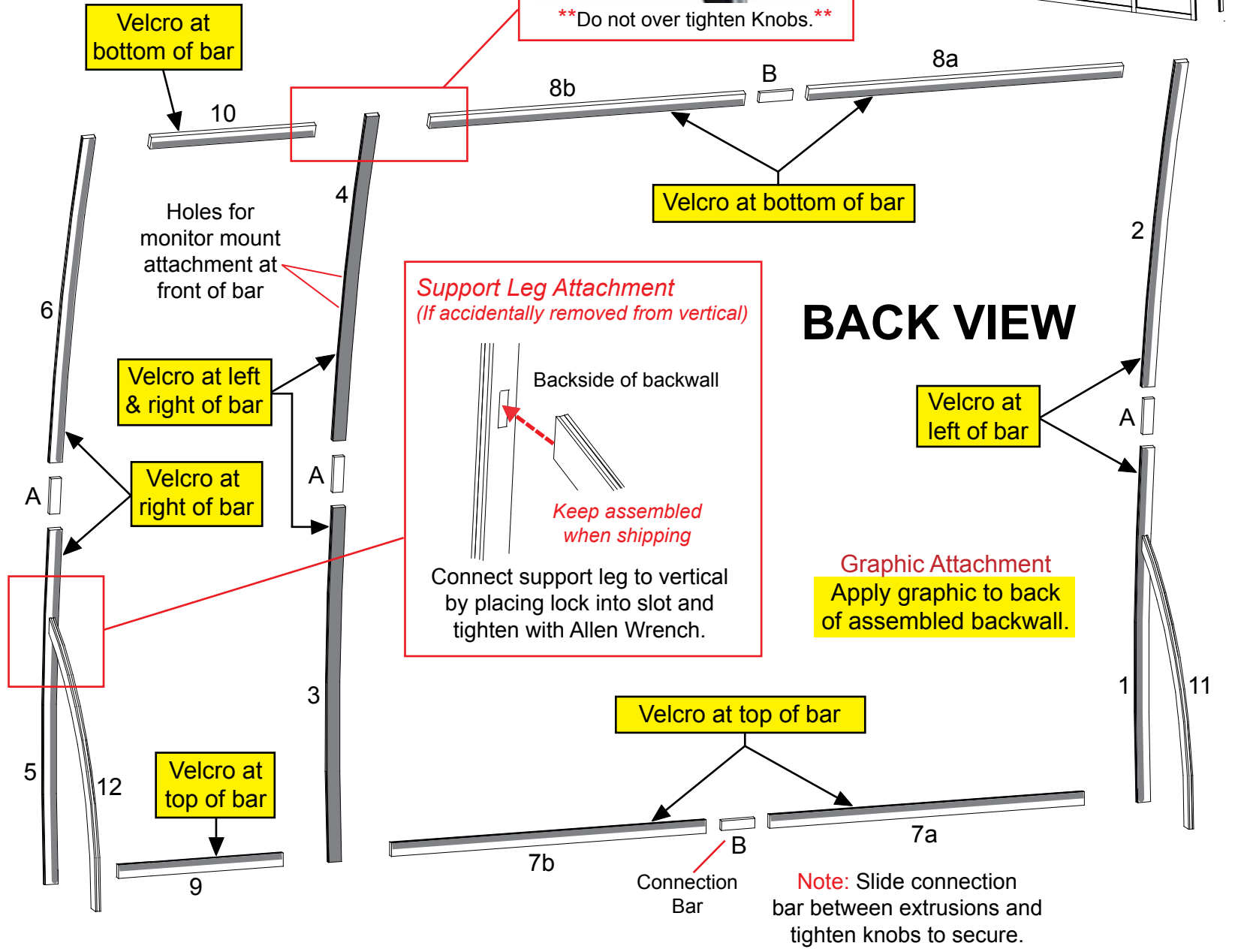
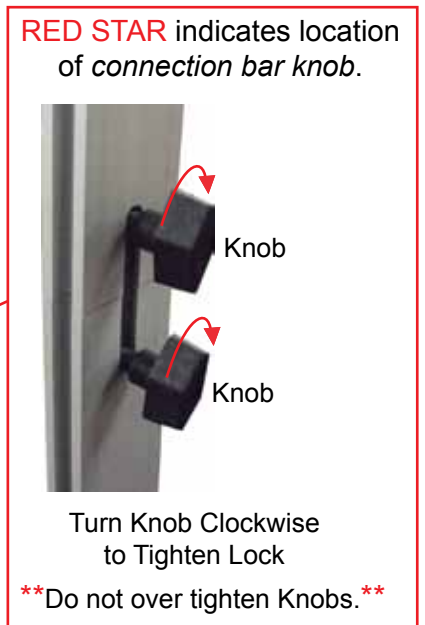
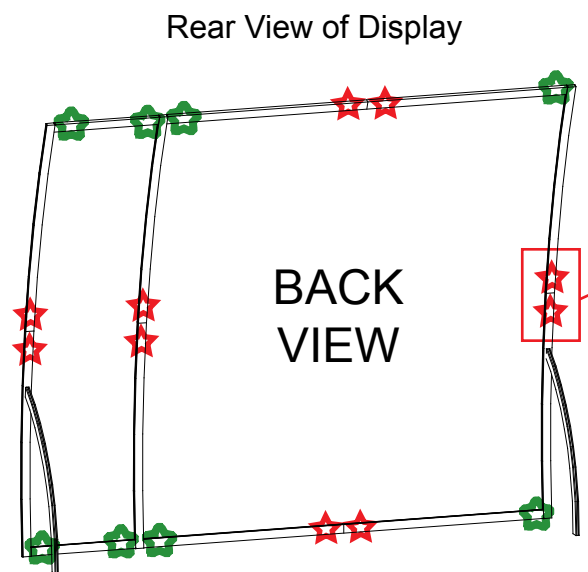

**WHEN DISASSEMBLING ALUMINUM EXTRUSION, TIGHTEN ALL SETSCREWS AND LOCKS TO PREVENT LOSS DURING SHIPPING**

866.652.2100

| Part Number | Qty | Description                      |
|-------------|-----|----------------------------------|
| 13          | 1   | Base Plate                       |
| 14          | 1   | 37.6"h Curved Vertical Extrusion |
| 14a         | 1   | Oval Flange Plate                |
| 15          | 1   | 18.5"w Horizontal Extrusion      |
| 16          | 1   | 15.69"w Horizontal Extrusion     |

Steps

- 1) Attach curved vertical [14] to base plate [13], see Base Plate Attachment detail.
- 2) Attach horizontal extrusions [15 and 16] between curved vertical [14] and backwall vertical [3] where indicated.
- 3) Attach flange plate to top of vertical [14] as shown.
- 4) Place counter top on assembled counter base, see Counter Attachment detail.
- 5) Attach monitor mount to assembled backwall.

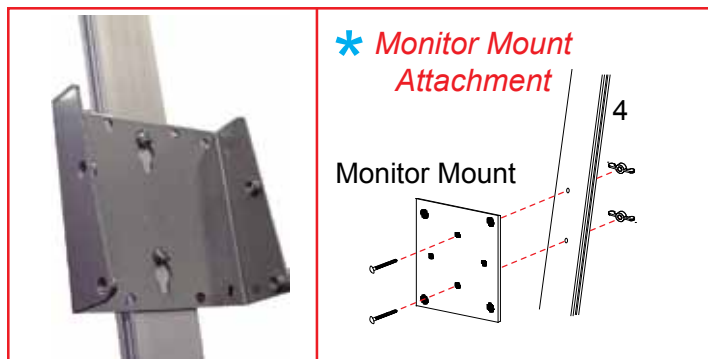
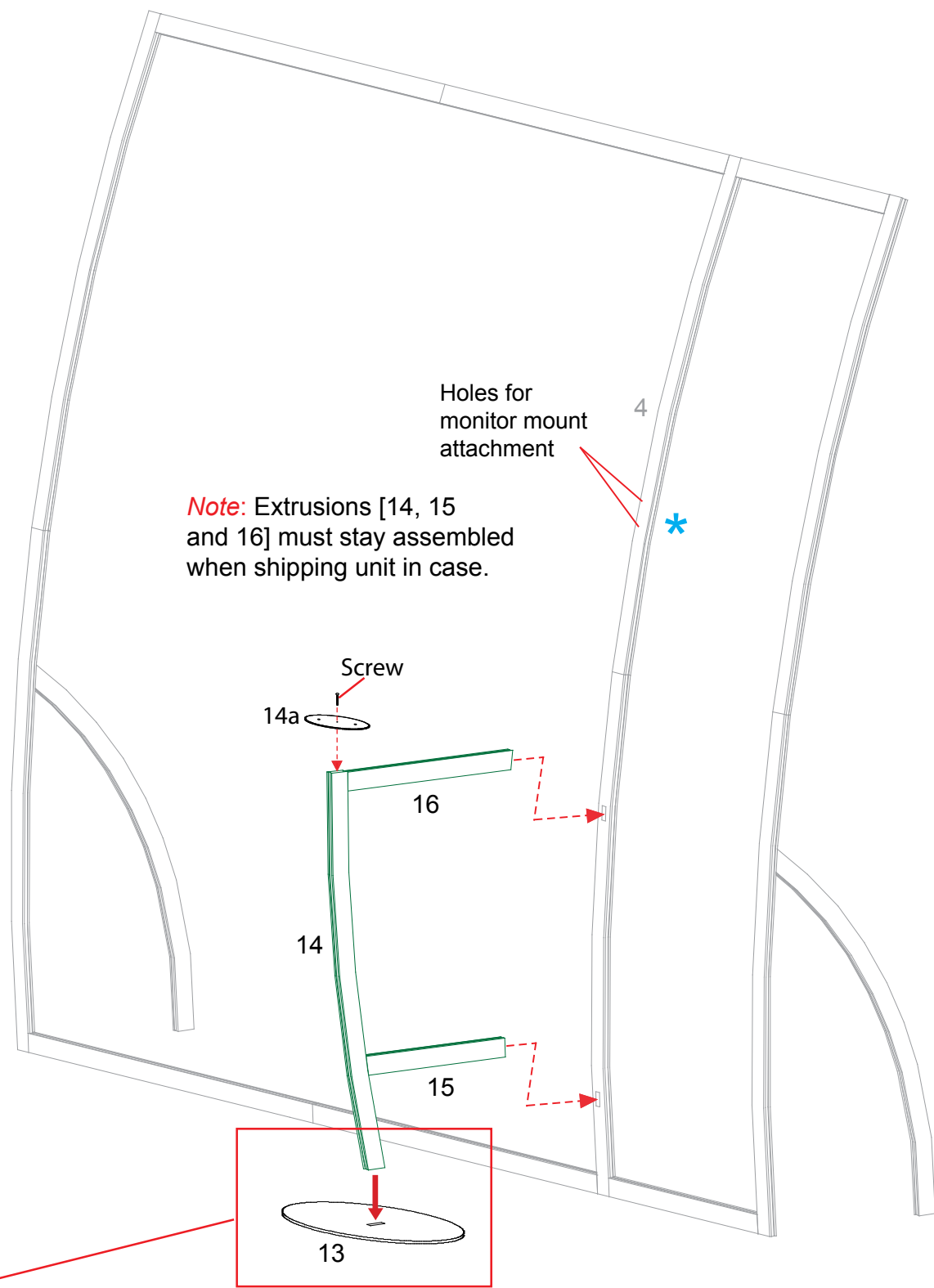

*Counter Top Attachment*

Insert screws located on underside of counter into holes on flange plate and secure with wing nuts.

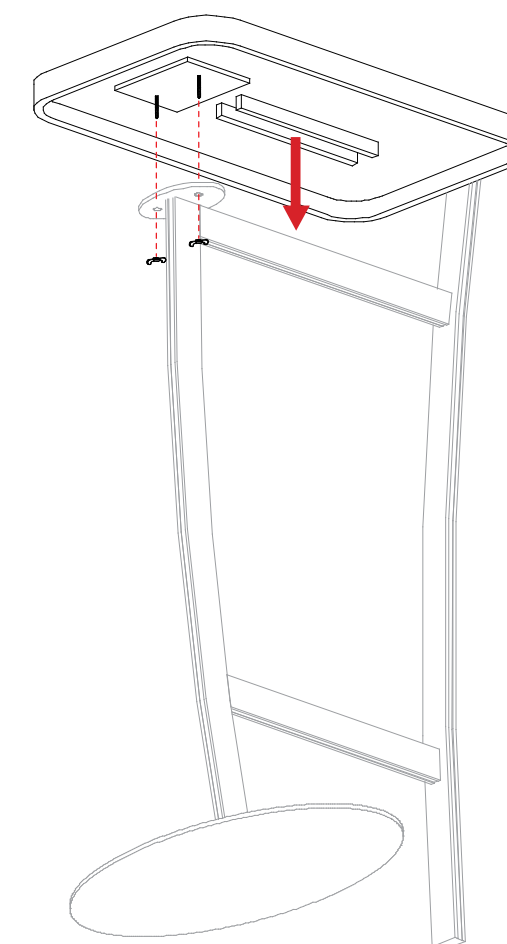

**WHEN DISASSEMBLING ALUMINUM EXTRUSION, TIGHTEN ALL SETSCREWS AND LOCKS TO PREVENT LOSS DURING SHIPPING**

866.652.2100

| Part Number | Qty | Description                   |
|-------------|-----|-------------------------------|
| 17          | 1   | 37.5"h Vertical Extrusion     |
| 18          | 1   | 37.5"h Corner Extrusion       |
| 19          | 1   | 37.5"h Corner Extrusion       |
| 20          | 1   | 37.5"h Vertical Extrusion     |
| 21/21a      | 4/2 | 11"w Horizontal Extrusion     |
| 22          | 2   | 24.875"w Horizontal Extrusion |

Steps

- 1) Attach horizontal extrusions [21 and 21a] between vertical extrusions [17&18 and 19&20], see Top View for extrusion orientation.
- 2) Attach curved horizontal extrusions [22] between corner extrusions [18 and 19], placing insert between curved horizontals.

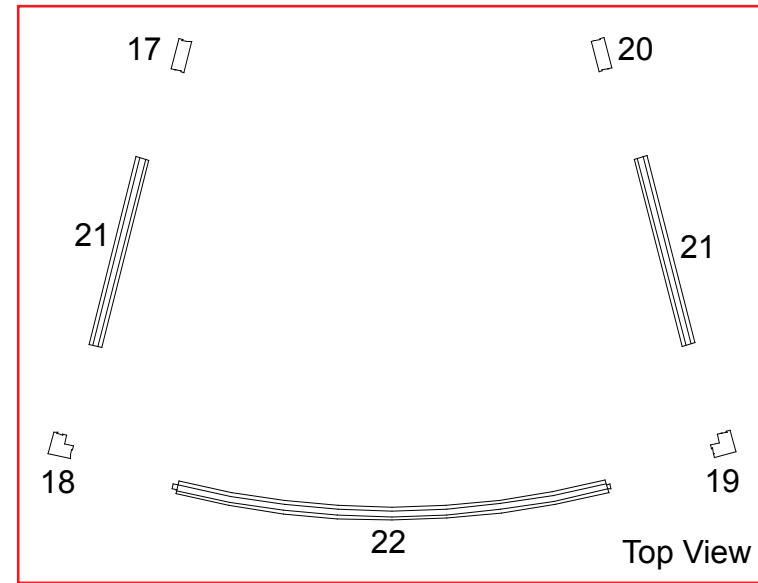

Steps (Cont'd):

- 3) Place shelf atop lip of extrusions.
- 4) Set counter top atop assembled base.

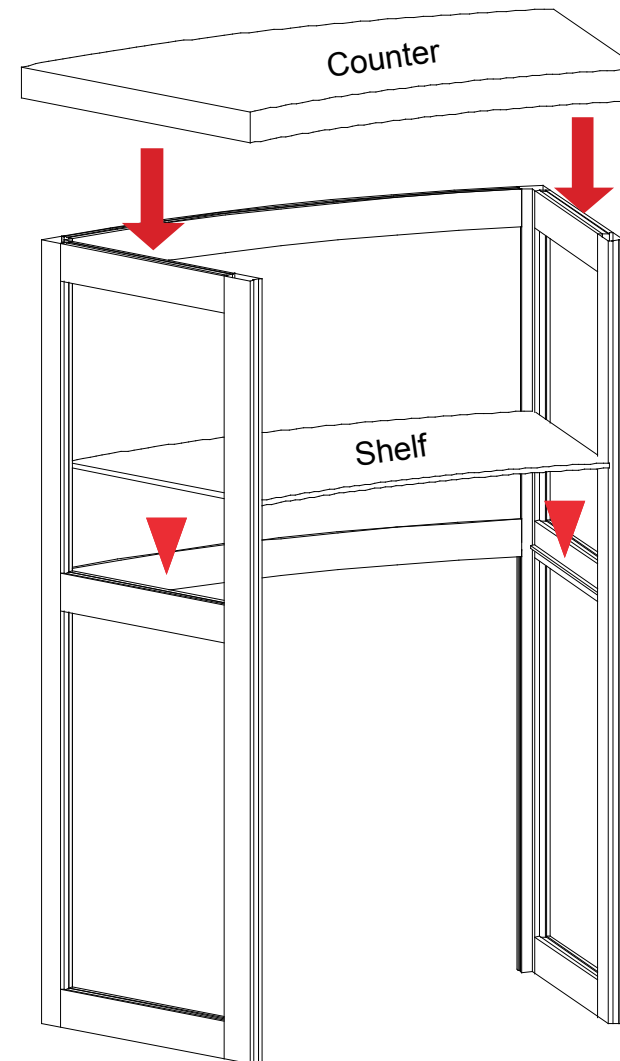
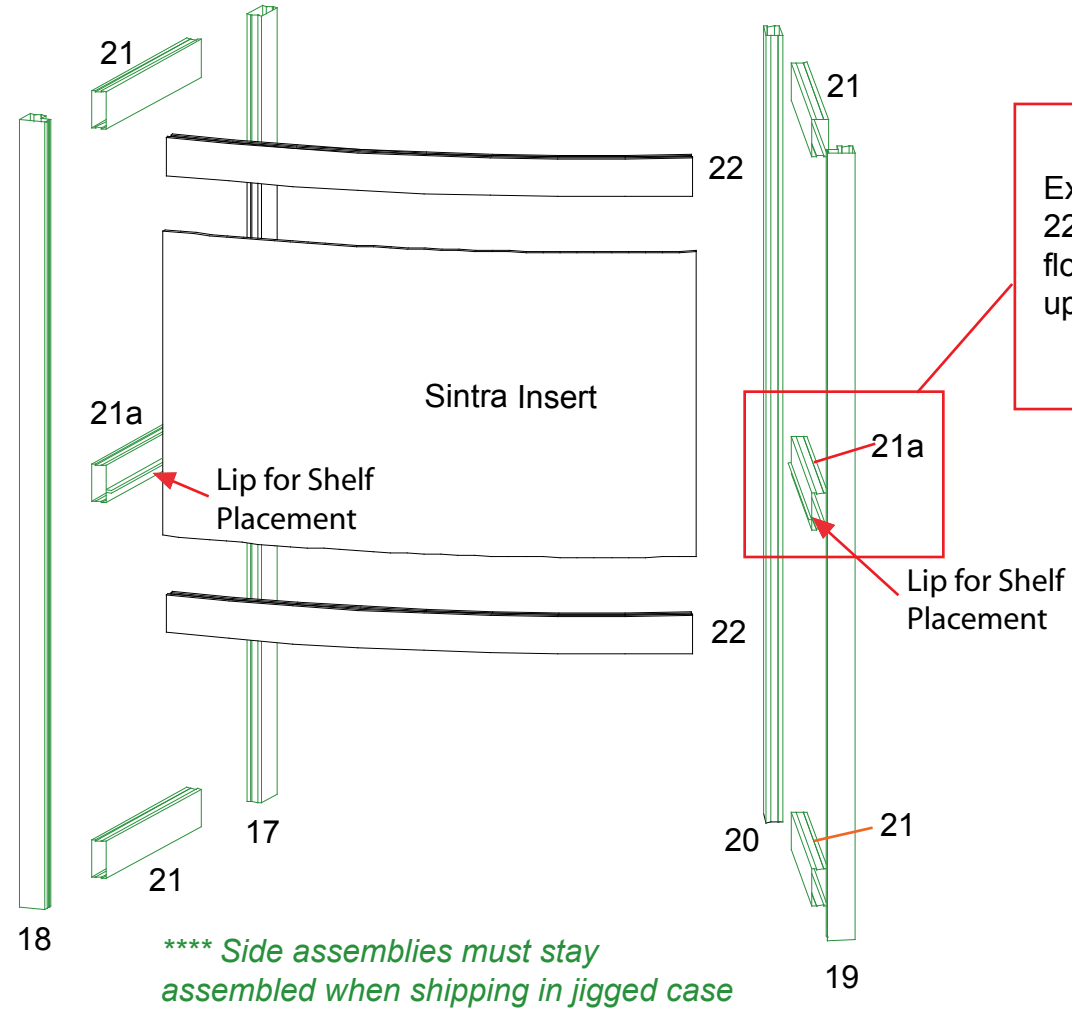
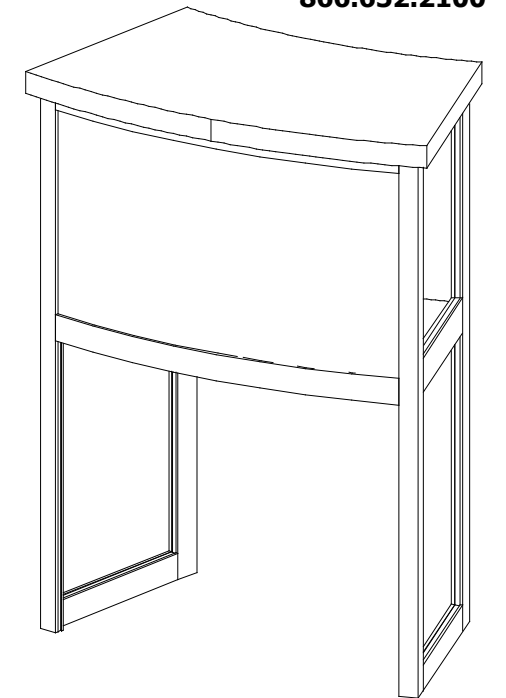

**WHEN DISASSEMBLING ALUMINUM EXTRUSION, TIGHTEN ALL SETSCREWS AND LOCKS TO PREVENT LOSS DURING SHIPPING**

### Top View of Each Level

#### Backwall Components

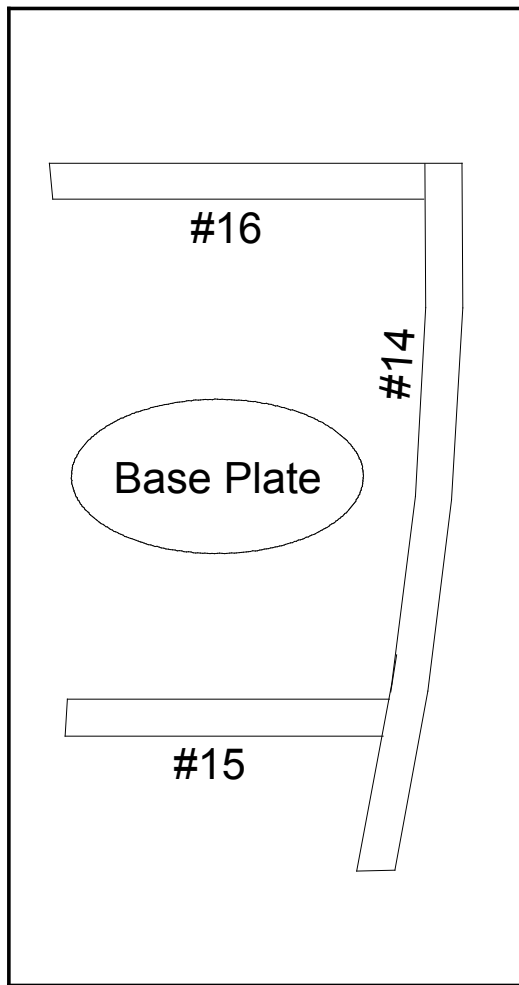

Level 1 (Bottom)

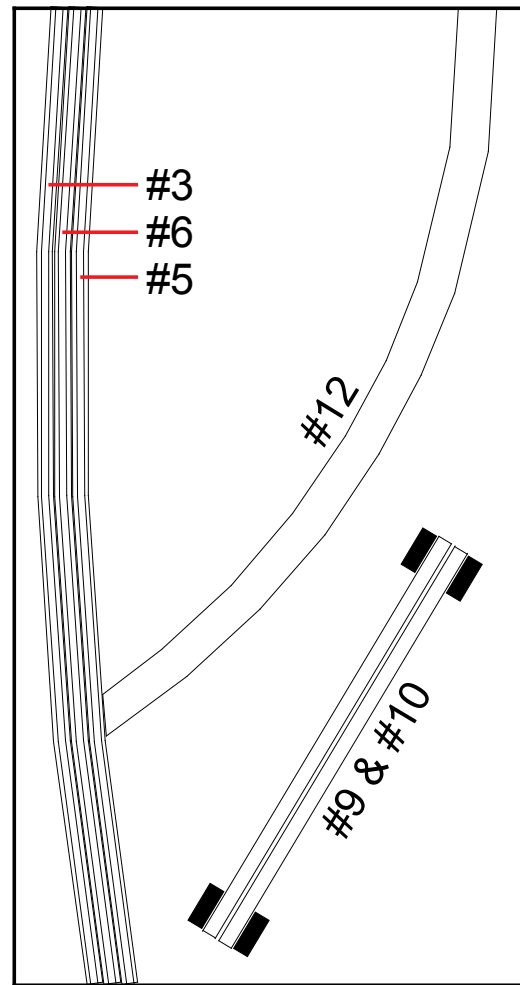

Level 2

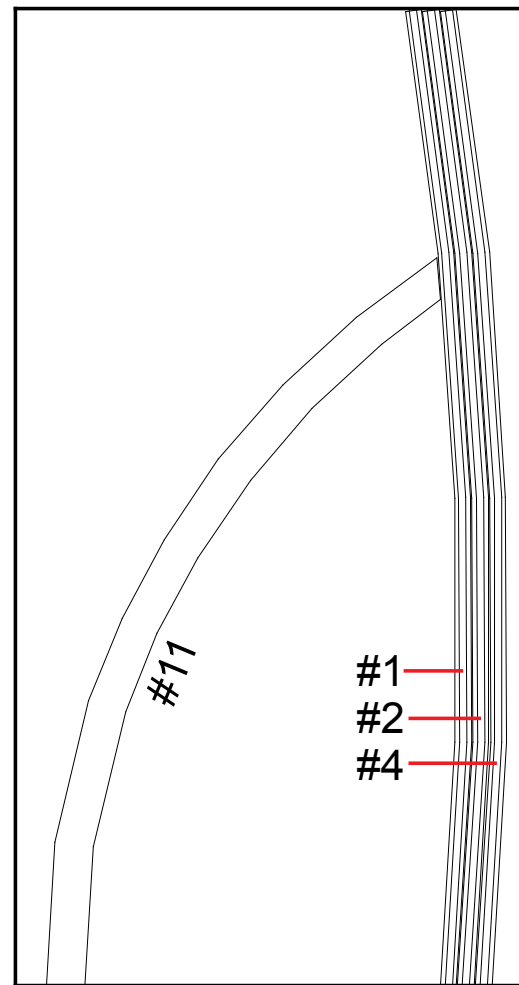

Level 3

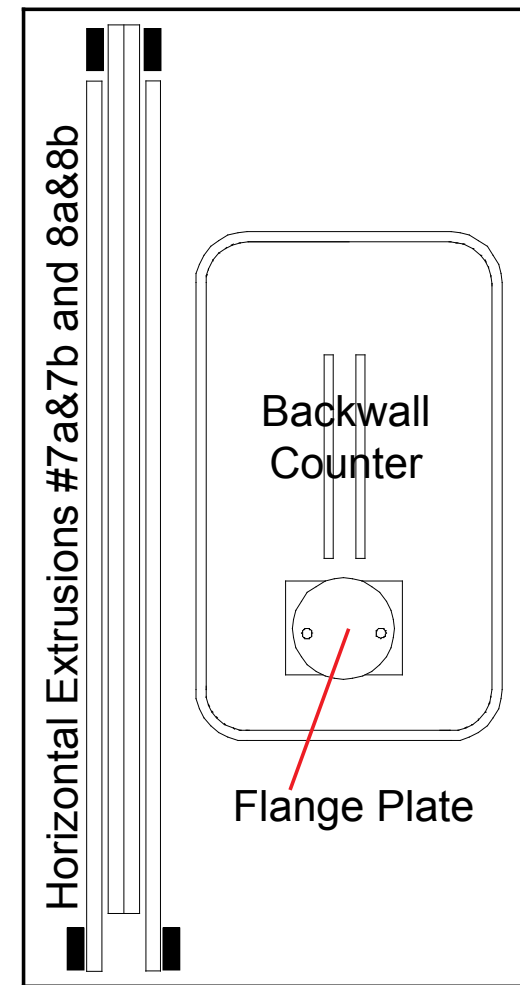

Level 4

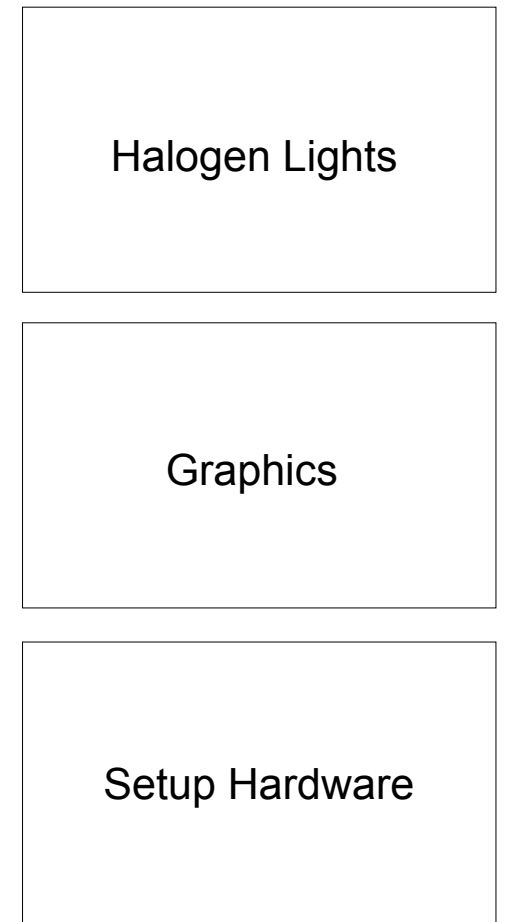

WHEN DISASSEMBLING ALUMINUM EXTRUSION, TIGHTEN ALL SETSCREWS AND LOCKS TO PREVENT LOSS DURING SHIPPING

### Top View of Each Level

### Pedestal Components

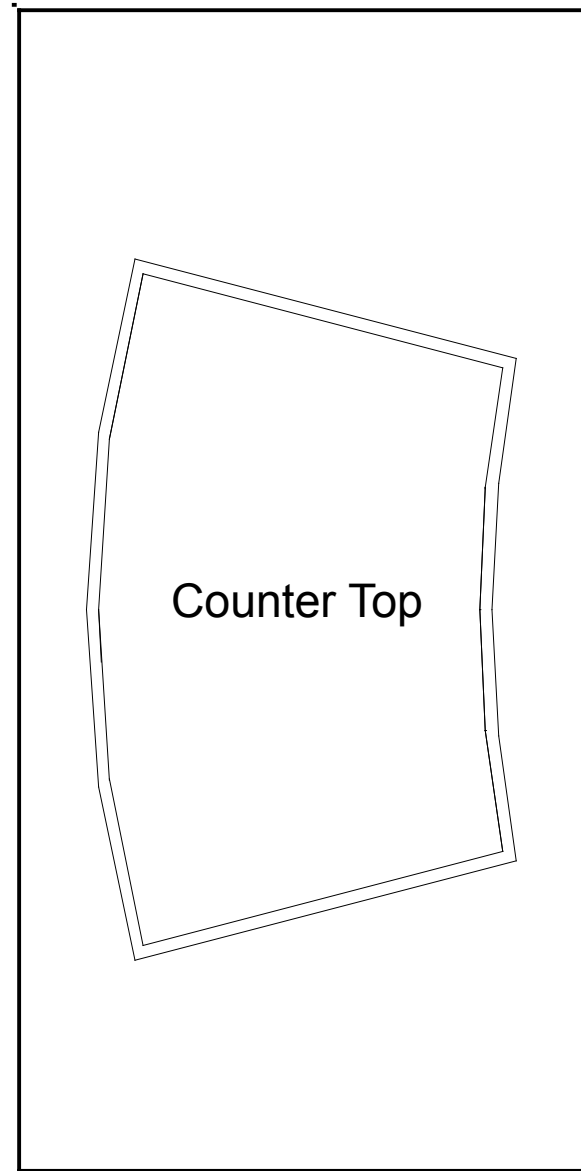

Level 1

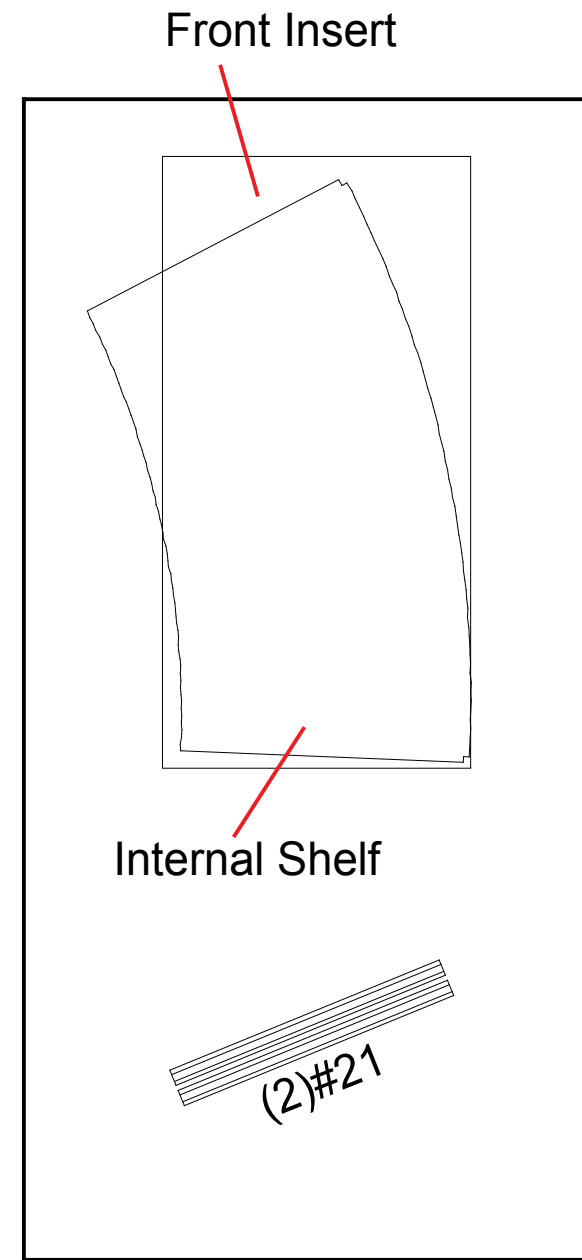

Level 2

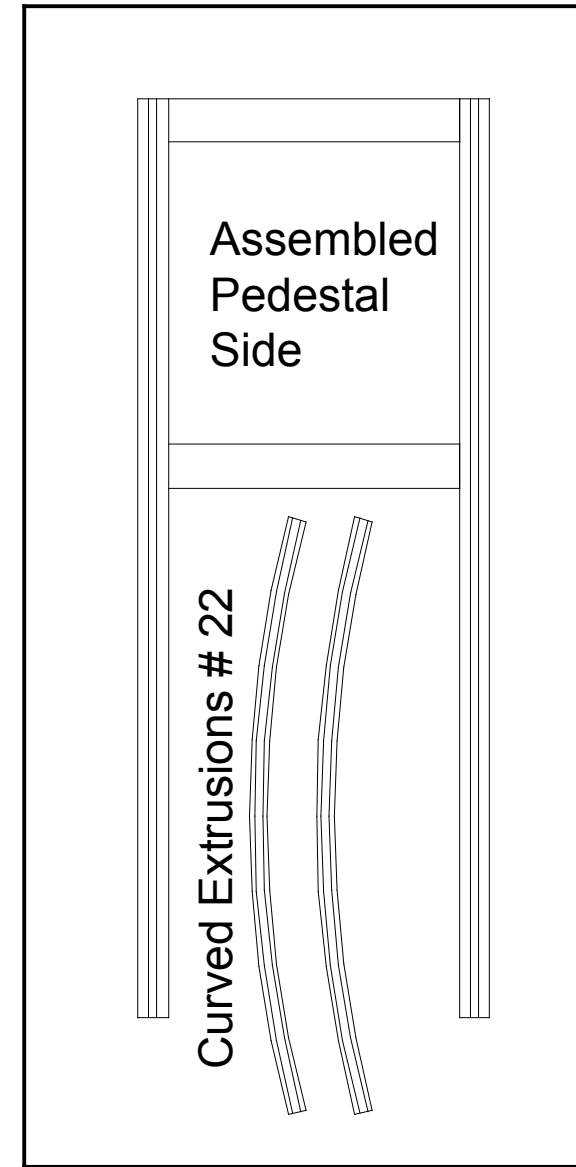

Level 3

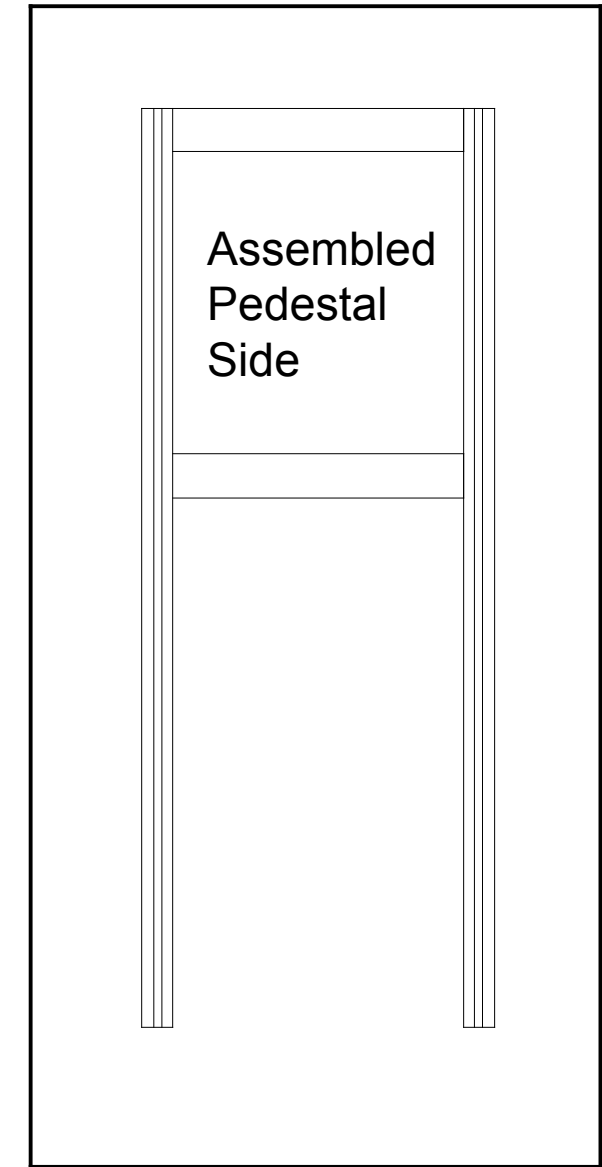

Level 4

WHEN DISASSEMBLING ALUMINUM EXTRUSION, TIGHTEN ALL SETSCREWS AND LOCKS TO PREVENT LOSS DURING SHIPPING